

Juniata County

Milford _____

8th 84.

~~Samuel Metlin~~ J^r

pt of Saml Metlin

Ret^d Dec. 22^d March. 1842.

in. al. W.

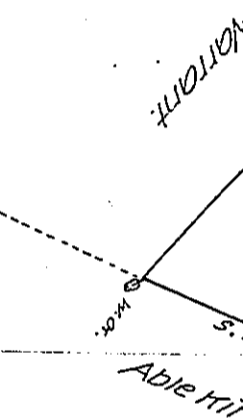

Able Hill

The above
 &c. Situate
 Warrant-gr
 ed June 10th
 To Jacob Sa
 Surveyor Ge

IN TESTIM